



35

TO LET  
**hawkins**  
Sales and Lettings  
024 7637 4949  
hawkingroup.co.uk  
find us first on  
www.themarket.co.uk

Stretton Road, Nuneaton, CV10 7ER

**hawkins**  
Sales and Lettings  
Trustworthy, Reliable, Responsive





# Property Description

This is a larger style middle terraced residence situated along this popular road just off Greenmoor Road which is available for immediate possession. The property has recently been improved throughout and now offers comfortable family accommodation worthy of an early viewing and benefits from gas fired central heating, upvc double glazing, driveway to the front, long rear garden and accommodation comprising: entrance hall, through lounge / diner, kitchen, rear lobby, ground floor bathroom. Landing and three bedrooms. Driveway and long rear garden.







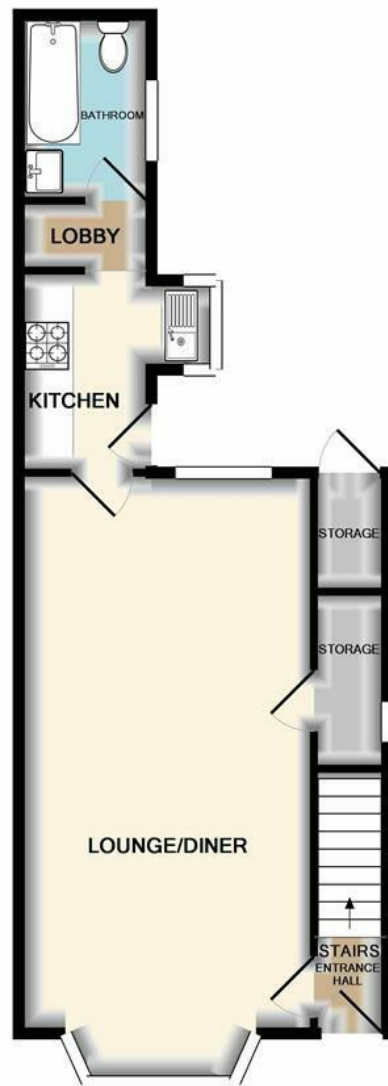

GROUND FLOOR  
APPROX. FLOOR  
AREA 43.5 SQ.M.  
(468 SQ.FT.)

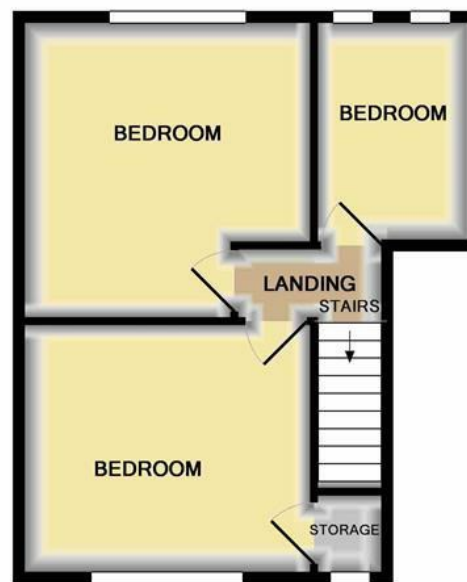

1ST FLOOR  
APPROX. FLOOR  
AREA 35.0 SQ.M.  
(377 SQ.FT.)

TOTAL APPROX. FLOOR AREA 78.4 SQ.M. (844 SQ.FT.)

Floor plans are produced and provided for illustration purposes only. Whilst every attempt has been made to ensure the plan is accurate and presents the property in the best way, measurements of doors, windows and rooms are approximate and no responsibility is taken for any error, omission or mis-statement.  
Made with Metropix ©2019

## Key Features

- Larger style mid terrace
- Sought after location
- Generous Lounge/diner
- Fitted kitchen
- Ground floor bathroom
- Three bedrooms
- Driveway & rear garden
- EPC RATING D Council Tax Band B

PCM  
£850 PCM

